

High Voltage Power Supplies

URL Series 0.3kV to 6kV 1.5W

1113-02A



FEATURES

- Small Size PCB Mountable
- High Performance, low Ripple
- Input/Output Proportional
- Input/Output Isolation

SUMMARY

URL series is a high performance, compact PCB mountable power supply.

This series is an input/output proportional module, and has a fully floating output of either polarity.

APPLICATIONS

- Photomultiplier Tubes
- Ionization Chambers
- High Voltage Bias
- E-chuck

Max. Output (KVdc)	Output Voltage (KVdc)	Output Current (mA)	MODEL	Rated load	Ripple (%p-p)	Input Voltage (Vdc)	Input Current typ (mA)	Insulation
			Reversible (I/O, Insulation)					Input/Output (Vdc)
0.3	0.03 to 0.3	5	URL-0.3PN	60K Ω	0.02	1.5 to 12	200	2000
0.6	0.04 to 0.6	2.5	URL-0.6PN	240K Ω	0.02			
1.1	0.08 to 1.1	1.36	URL-1.1PN	800K Ω	0.025			
1.5	0.1 to 1.5	1	URL-1.5PN	1.5M Ω	0.025			
2	0.15 to 2	0.75	URL-2PN	2.6M Ω	0.025	1.5 to 15		3000
3	0.2 to 3	0.5	URL-3PN	6M Ω	0.025			
5	0.25 to 5	0.3	URL-5PN	16M Ω	0.2			
6	0.4 to 6	0.25	URL-6PN	24M Ω	0.2			

SPECIFICATIONS

Output Voltage Proportional to input voltage (See table)

Output Power 1.5W MAX

Regulation 5% typ(50% to 100% load)

Protection All units are protected against input reverse connection and intermittent output short circuits.

Temperature range Operating : -10°C to 60°C
Storage : -40°C to 85°C

Humidity 20% to 80%RH(no condensation)

OPTIONS

LMB Metal shield Box (for 0.3 to 2kV model only)

☆ Please ask for better ripple model

☆ Add "LMB" to the model number when ordering

☆ Consult to sales office for models over 3kV.

CONNECTION DIAGRAM

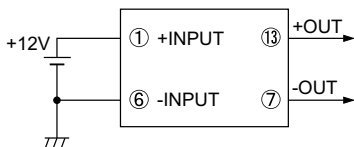

Note : These specifications are at the maximum rated output after a warm-up period unless otherwise specified.

DIMENSIONS inch

BOTTOM VIEW

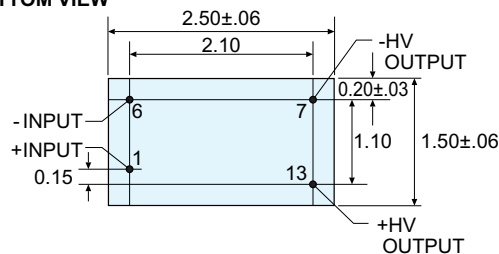

SIDE VIEW

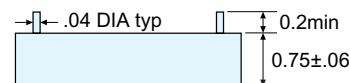

INPUT/OUTPUT PROPORTIONAL CHARACTERISTIC

