

# High Voltage Power Supplies

UR Series 0.3kV to 6kV 3W

1039-05P



## FEATURES

- Small Size PCB Mountable
- High Performance, low Ripple
- Input/Output Proportional
- Input/Output Isolation

## SUMMARY

UR series is a high performance, compact PCB mountable power supply.

This series is an input/output proportional module, and has a fully floating output of either polarity.

## APPLICATIONS

- Photomultiplier Tubes
- Ionization Chambers
- High Voltage Bias
- CRT

Max. Output (KVdc)	Output Voltage (KVdc)	Output Current (mA)	MODEL	Rated load (K $\Omega$ • M $\Omega$ )	Ripple (%p-p)	Input Voltage (Vdc)	Input Current TYP (mA)	Insulation
			Reversible (I/O, Insulation)					Input/Output (Vdc)
0.3	0.03 to 0.3	10	UR-0.3PN	30K $\Omega$	0.02%	1.5 to 12V	380	2000
0.6	0.04 to 0.6	5	UR-0.6PN	120K $\Omega$				
1.1	0.08 to 1.1	2.75	UR-1.1PN	400K $\Omega$				
1.5	0.1 to 1.5	2	UR-1.5PN	750K $\Omega$	0.03%			
2	0.15 to 2	1.5	UR-2PN	1.3M $\Omega$				
3	0.2 to 3	1	UR-3PN	3M $\Omega$	0.1%			
5	0.25 to 5	0.6	UR-5PN	8M $\Omega$				
6	0.4 to 6	0.5	UR-6PN	12M $\Omega$	0.2%	3000		
								5000
								6000

## SPECIFICATIONS

<b>Output Voltage</b>	Proportional to input voltage (See table)
<b>Output Power</b>	3W MAX
<b>Regulation</b>	5% typ (50% to 100% load)
<b>Protection</b>	All units are protected against input reverse connection and intermittent output short circuits.
<b>Temperature range</b>	Operating : -10 to 60°C Storage : -20 to 60°C

## OPTIONS

**LMB** Metal shield Box (for 0.3 to 2kV model only)

- ☆ Please ask for better ripple model
- ☆ Add "LMB" to the model number when ordering
- ☆ Consult to sales office for models over 3kV.

## CONNECTION DIAGRAM

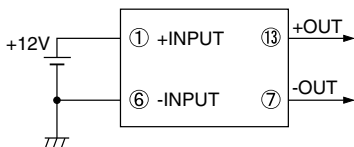

Note : These specifications are at the maximum rated output after a warm-up period unless otherwise specified.

## DIMENSIONS inch

### BOTTOM VIEW

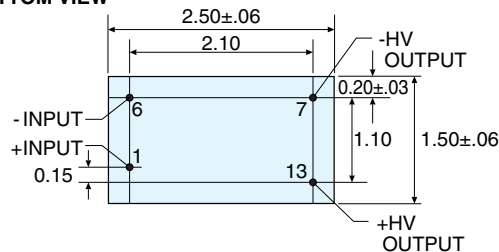

### SIDE VIEW

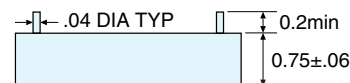

## INPUT/OUTPUT PROPORTIONAL CHARACTERISTIC

